

45° ELBOW BRACE DETAIL

NOTE: BRACES HAVE 4-INCH LONG TACK WELD INSIDE  
RECTANGULAR END FOR ADDITIONAL STRENGTH

PRODUCT SPECIFICATION - 45° ELBOW

PRODUCT LIST

PRODUCT DIMENSIONS

ROUND EQUIV.	DIMENSIONS	MODEL	ROUND AREA (SQ. IN.)	A	B	C	D	E	F	G	NUMBER OF BRACES
8"	3"x17"	CP-SP4517	50.027	17.269"	3.269"	10 GA.	17.50"	3.5"	3"	17"	1
8"	4"x14"	CP-SP4514	50.027	14.269"	4.269"	10 GA.	14.50"	4.5"	4"	14"	
10"	3"x27"	CP-SP4527	78.854	27.269"	3.269"	10 GA.	27.50"	3.5"	3"	27"	2
10"	4"x22"	CP-SP4522	78.854	22.269"	4.269"	10 GA.	22.50"	4.5"	4"	22"	1
12"	4"x28"	CP-SP4528	111.931	28.269"	4.269"	10 GA.	28.50"	4.5"	4"	28"	2

MATERIAL: 10 GAUGE GALVANIZED A653 G90, MEETS ASTM A-653. TENSILE STRENGTH 50,000. YIELD 36,000. ALL WELDS WILL BE SPRAYED, ROLLED OR BRUSHED WITH GALVANIZED #95 COATING. RECTANGULAR CONNECTION: MASTIC (MUST MEET OR EXCEED ASTM D-4586), CAULKING, EPOXY OR OTHER CITY OF LOS ANGELES APPROVED METHOD. ROUND CONNECTION: CAST IRON/ PLASTIC PIPE CONNECTION USE CAST IRON OR PLASTIC TO STEEL COUPLINGS. CONTACT BUREAU OF CONTRACT ADMINISTRATION MATERIAL CONTROL SECTION AT (213) 485-5080 FOR FABRICATION INSPECTION

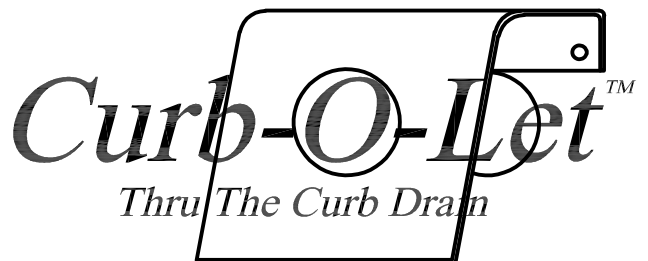

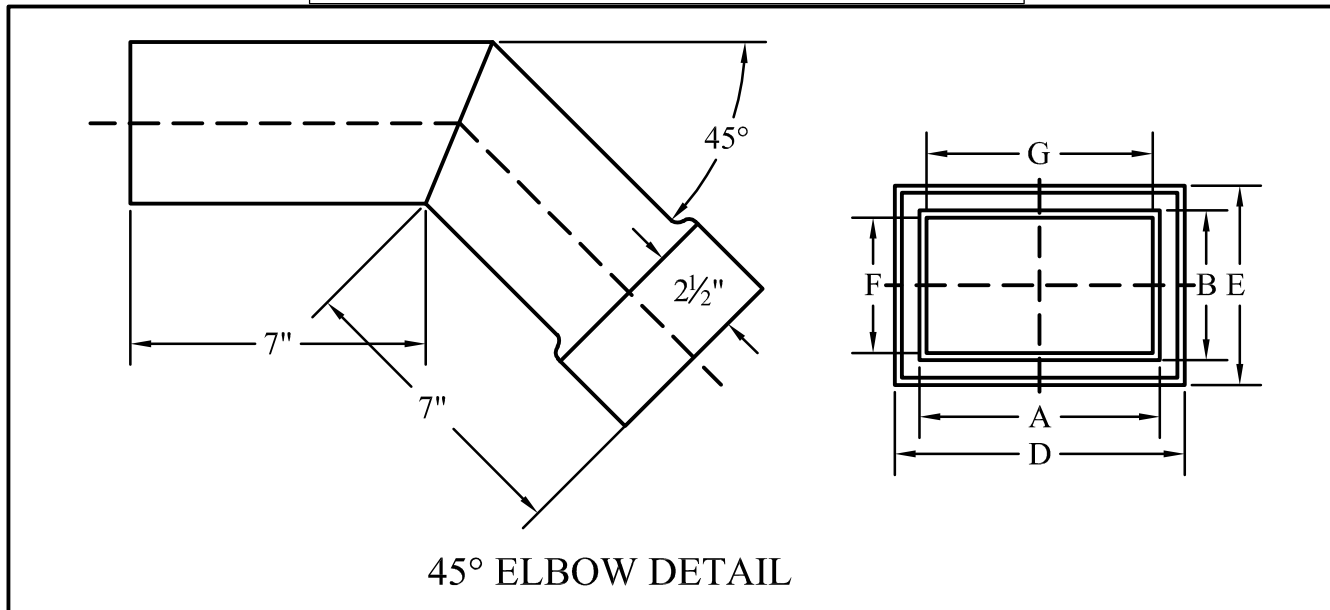

45° ELBOW DETAIL

NOTE: BRACES HAVE 4-INCH LONG TACK WELD INSIDE RECTANGULAR END FOR ADDITIONAL STRENGTH

PRODUCT SPECIFICATION - 45° ELBOW

PRODUCT LIST

PRODUCT DIMENSIONS

ROUND EQUIV.	DIMENSIONS	MODEL	ROUND AREA (SQ. IN.)	A	B	C	D	E	F	G	NUMBER OF BRACES
4"	3"x5"	CP-SP455	12.730	5.269"	3.269"	10 GA.	5.5"	3.5"	3"	5"	
5"	3"x8"	CP-SP458	20.005	8.269"	3.269"	10 GA.	8.5"	3.5"	3"	8"	
6"	3"x12"	CP-SP4512	28.890	12.269"	3.269"	10 GA.	12.5"	3.5"	3"	12"	
8"	3"x17"	CP-SP4517	50.027	17.269"	3.269"	10 GA.	17.50"	3.5"	3"	17"	1
8"	4"x14"	CP-SP4514	50.027	14.269"	4.269"	10 GA.	14.50"	4.5"	4"	14"	
10"	3"x27"	CP-SP4527	78.854	27.269"	3.269"	10 GA.	27.50"	3.5"	3"	27"	2
10"	4"x22"	CP-SP4522	78.854	22.269"	4.269"	10 GA.	22.50"	4.5"	4"	22"	1
12"	4"x28"	CP-SP4528	111.931	28.269"	4.269"	10 GA.	28.50"	4.5"	4"	28"	2

MATERIAL: 10 GAUGE GALVANIZED A653 G90, MEETS ASTM A-653. TENSILE STRENGTH 50,000. YIELD 36,000. ALL WELDS WILL BE SPRAYED, ROLLED OR BRUSHED WITH GALVANIZED #95 COATING. RECTANGULAR CONNECTION: MASTIC (MUST MEET OR EXCEED ASTM D-4586), CAULKING, EPOXY OR OTHER CITY OF LOS ANGELES APPROVED METHOD. ROUND CONNECTION: CAST IRON/ PLASTIC PIPE CONNECTION USE CAST IRON OR PLASTIC TO STEEL COUPLINGS. CONTACT BUREAU OF CONTRACT ADMINISTRATION MATERIAL CONTROL SECTION AT (213) 485-5080 FOR FABRICATION INSPECTION

